

Charming Bed Pocket by Cori Blunt of Chitter Chatter Designs



Fabric Requirements:

1/2 Yard for Background Fabric (White print)

1/4 Yard for Ruffle/Pocket Trim (Stripe)

1/3 Yard for Pocket/Straps (Plaid)

Two coordinating 1" Buttons, if desired.

Embroidery Floss in Green, Pink, Brown, & White

For Appliqués: Small swatches of fabric in Pink –Hearts; Floral –Roses;

Green – Birds; Salmon – Bird Belly's.

Cutting Instructions:

Background fabric should be 18" x width of fabric.

From Ruffle/Pocket Trim Fabric – cut one strip 6"x the width of the fabric (ruffle). Cut one strip 1 1/2" x 18" (pocket trim.)

From Pocket/Strap Fabric – cut a strip 3 1/2"x width of the fabric (Straps.) Cut an 8 1/2" strip x the width of the fabric, cut into 18" lengths making two strips 8 1/2" x 18" strips (pocket.)

Appliqué Instructions:

If you choose to appliqué the birds, hearts, and flowers, you will need to prepare your appliqués using your preferred method. I use a modified needle turn method in which I trace my design onto the dull side of freezer paper with a pencil. I cut out the paper pattern and iron it, shiny side down, to the right side of my fabric. I cut out the piece 1/4" bigger than the paper pattern and position it into place. I turn under the seam allowance with my needle to match the paper as I go. When I have finished, I simply peel away the paper. On page two I have listed a step by step instruction of how I appliqué my pieces.

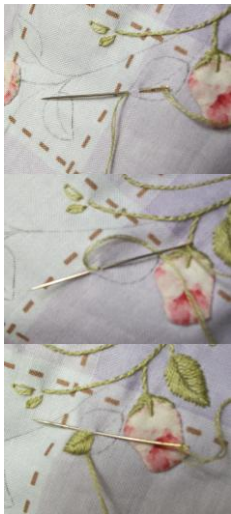

1. I trace my design onto a piece of freezer paper. I then position the pattern onto my pocket and iron it – shiny side down – to the front pocket piece.
2. I cut out the heart and iron it to the fabric swatch I have chosen for the appliqué, prepare as mentioned on page one. I use the traced design as a template to position the heart into place. I pin it down and remove the template. I appliqué the piece into place.
3. When both hearts are appliquéd in the manner described above, I outlined both hearts using a stem stitch. Using a satin stitch, I stitched the inner heart.
4. When the hearts were completed, I cut out the lines of the vines, cut out the leaves, all the while being careful to keep the template as intact as possible.
5. When all was cut out, I ironed my template back into position on the pocket. Using a mechanical pencil, I traced within the cut out to transfer my embroidered part of the design onto the pocket front, that being leaves and vines.
6. I fussy cut the flower appliqué using a floral fabric as shown in the picture. I appliquéd the five roses into position using my penciled lines.
7. I used a stem stitch to embroider on the vine lines and leaf stem lines. Use a lazy daisy stitch where indicated on the small leaves.
8. I used a fishbone stitch on the leaves. Start with a single stitch on the leaf top as shown; then position your needle to one side of the first stitch from center to outer line, followed by the same stitch on the other side. Continue in this manner until your leaf is complete.
9. Use the same techniques as described above to complete your humming birds. The belly is appliquéd first, followed by far wing, tail, body/head, and closest wing last. I used a stem stitch in green for the line details on the wings and tail. I used a satin stitch in brown for the eye and beak. A French knot was used in white for the eye highlight.

You may choose to do the pocket in embroidery only, using Helen's colourque technique (picture #1). Or if appliqué and embroidery is just not for you... it still looks cute without anything but a wonderful printed fabric! (picture #2)



Bed Pocket Assembly Instructions

All seam allowances are 1/4". Remember to press all seams.



Appliqué or embroider pocket front if desired. Appliqué and embroidery instructions detailed on a previous page.



Right sides together, sew the trim strip to the top of your pocket front. Sew the pocket back to the other side of your striped strip.



Fold right sides together and sew down each side to create your pocket. Turn right side out and press. Top stitch just under the stripe seam at the top of the pocket.



Right sides together, fold ruffle in half lengthwise and sew ends closed. Turn right sides out, and press ruffle in half lengthwise. Sew two gathering lines using a long stitch length and gather ruffle to 18" long.



Match the ruffle to the bottom of the pocket back and sew the ruffle to the pocket back only. The pocket front shouldn't be included.



Flip the pocket over to the front. Turn under the seam allowance and pin to the ruffle as shown above.



Sew the pocket tab right sides together lengthwise. Turn right side out and press. Cut the tab in half, and turn under the seam allowance on one end of each tab. Pin the turned under ends about 4" from each pocket end as shown and sew as indicated above. Sew buttons on tabs.



Fold the background fabric in half, right sides together matching up the selvages. Sew from fold to selvage on each end (22" sides.) Turn right side out and press. Position the pocket so that the bottom of the pocket matches up with the fold of the background fabric. Pin into place.



Place tabs straight as shown and match tabs to the top of the background fabric. Trim off excess fabric.



Turn under the selvage edge on top and pin turning the tab inside the seam allowance when you come to it.



Sew around the edge of the whole piece removing pins as you go.



Position the top of your bed pocket between your mattress and box spring and secure with mattress pins, or safety pins.

Charming Bed Pocket

Applique / Embroidery Pattern

Embroider lines in colors shown.
Follow instructions for applique.

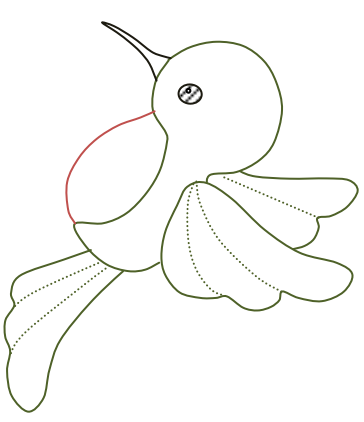
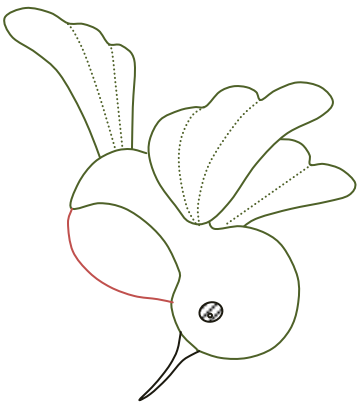

Chitter Chatter Designs

©2009 Cori Blunt